



Spacious South-Facing One Bedroom Apartment

WHEELER GARDENS

ISLINGTON, N1

Asking Price
£499,950

**BERKSHIRE
HATHAWAY**
HOMESERVICES

LONDON

PROPERTY DETAILS

Guide Price £499,950	Square Footage 515
Council Tax Band TBC	EPC C
Ground Rent £10 pa	Service Charge £1788 pa
Tenure Leasehold	

This charming one bedroom apartment is ideal for first time buyers or anyone needing a City base. Located on the first floor, the flat boasts modern features throughout, including a newly fitted kitchen and a walk-in wardrobe providing ample storage. With both the main living space and bedroom facing South-West, the property benefits from beautiful afternoon sun which floods the flat with natural light creating an enviable atmosphere throughout.

Wheeler Gardens is exceptionally well located with nearby transport links including St. Pancras International and King's Cross Station (Northern, Victoria, Hammersmith & City, Metropolitan, Circle and Piccadilly lines, National Rail) providing frequent services into the City and the West End.

Vibrant Coal Drops Yard and Granary Square are also moments away.

FEATURES

- One Bedroom
- One Reception Room
- One Bathroom
- South-Facing
- First Floor
- Modern Features
- Communal Gardens
- Fitted Kitchen

LOCATION

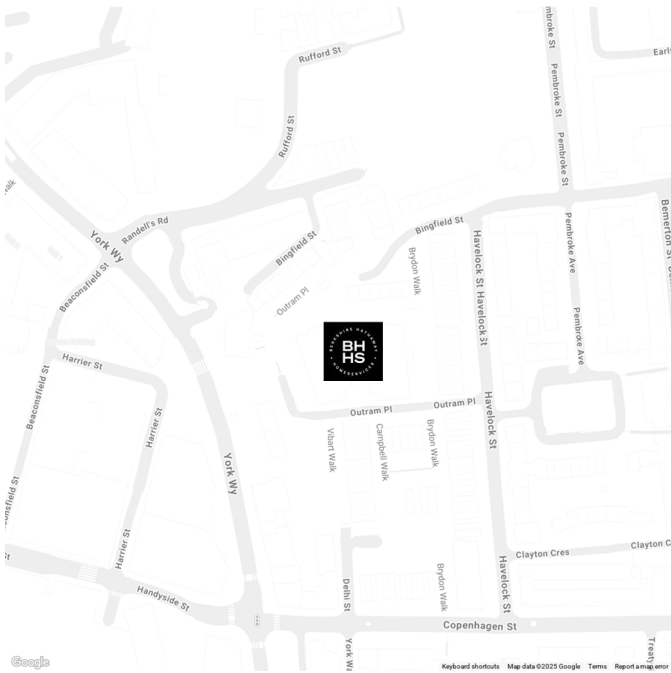

KINGS CROSS SALES
Unit 4,6 Pancras Square, N1C 4AG

020 7467 2020
sales.kingscross@bhhs-london.com



FLOORPLAN

Wheeler Gardens

Approx. Gross Internal Area 517 Sq Ft - 48.03 Sq M

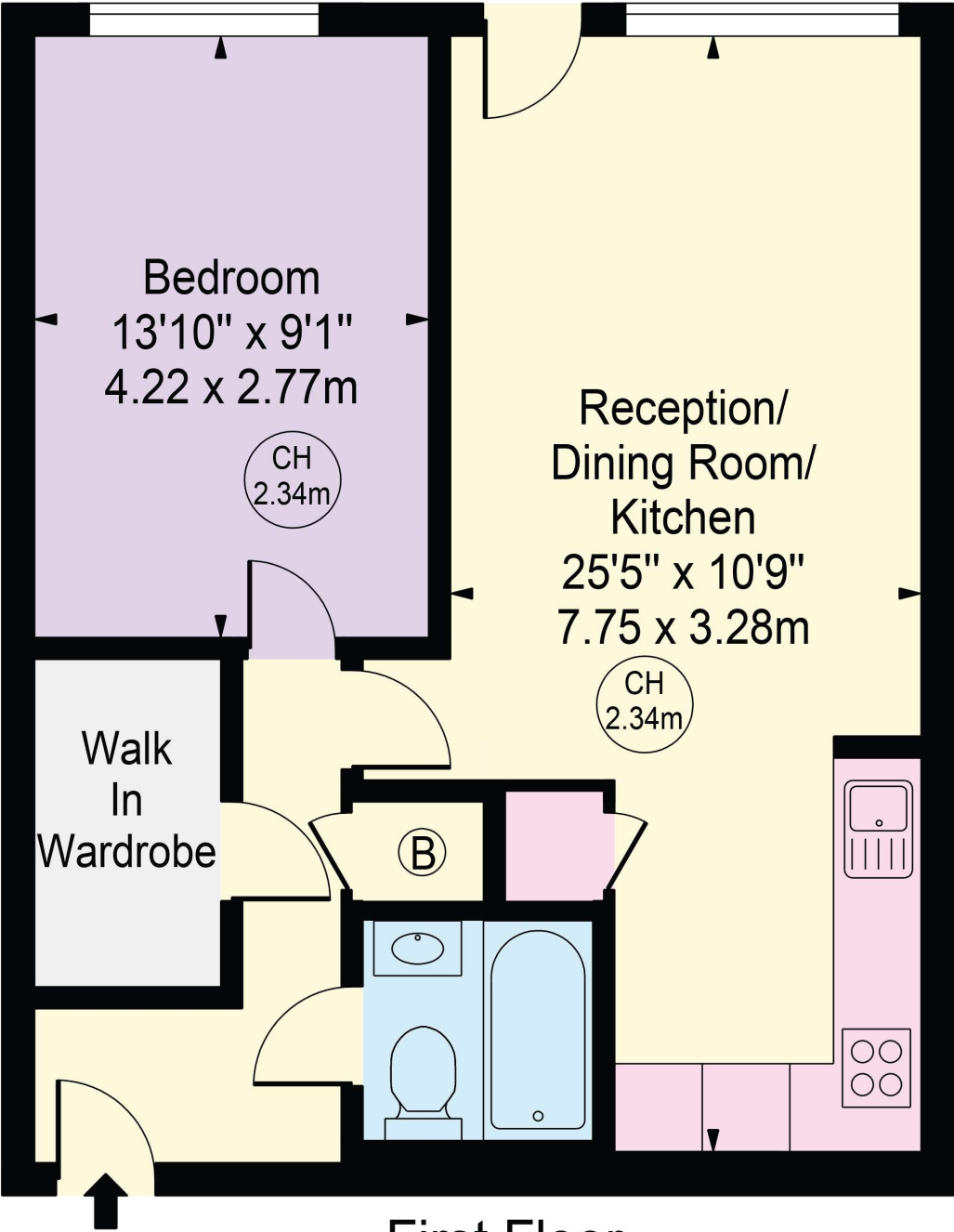

First Floor

For Illustration Purposes Only - Not To Scale

This floor plan should be used as a general outline for guidance only and does not constitute in whole or in part an offer or contract. Any intending purchaser or lessee should satisfy themselves by inspection, searches, enquiries and full survey as to the correctness of each statement. Any areas, measurements or distances quoted are approximate and should not be used to value a property or be the basis of any sale or let.