



Modern Elegance on One of South Kensington's Finest
Garden Squares

CORNWALL GARDENS

SOUTH KENSINGTON, SW7

Asking Price
£1,100,000

**BERKSHIRE
HATHAWAY**
HOMESERVICES

LONDON

PROPERTY DETAILS

Guide Price £1,100,000	Square Footage 658
Council Tax Band G	EPC D
Tenure Share of Freehold	Service Charge £6,000.00 pa

Set within an impressive period property, this contemporary two-bedroom, two-bathroom flat boasts sweeping dual-aspect views over the picturesque Cornwall Gardens. Now available, the home features a spacious open-plan kitchen with a central island, two generous double bedrooms, two stylish bathrooms, elegant wooden flooring throughout, and large sash windows that flood each room with natural light. Ample storage is thoughtfully integrated throughout. Ideally located in the prestigious Cornwall Gardens, the flat is just moments from Gloucester Road Underground Station and within easy reach of South Kensington, the Royal Albert Hall, and the Natural History Museum.

FEATURES

- Two Bedrooms
- One Reception Room
- Two Bathrooms
- Off Street Parking
- Upper Floor
- Wood Flooring
- Communal Gardens
- Impressive Period Property

LOCATION

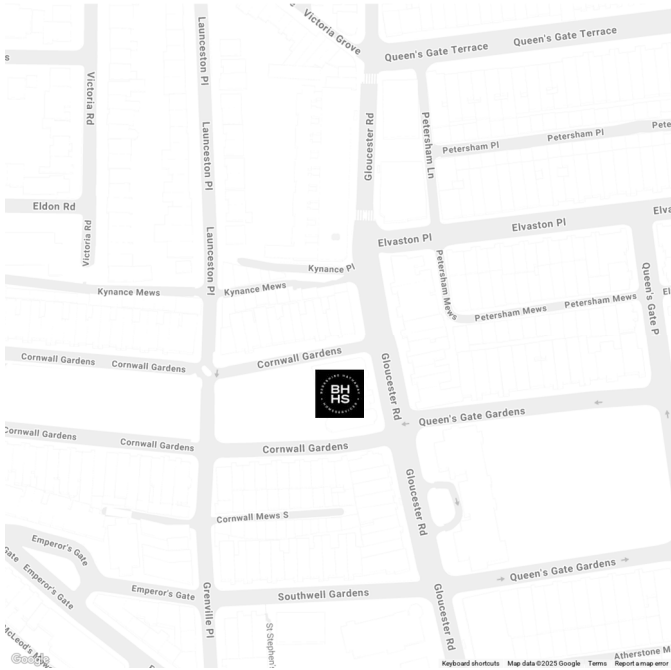

KNIGHTSBRIDGE SALES
55-57 SLOANE AVENUE, SW3 3DH

020 7235 9641
sales.knightsbridge@bhhs-london.com



FLOORPLAN

CORNWALL GARDENS

APPROXIMATE GROSS INTERNAL FLOOR AREA: 639 SQ FT - 59.41 SQ M

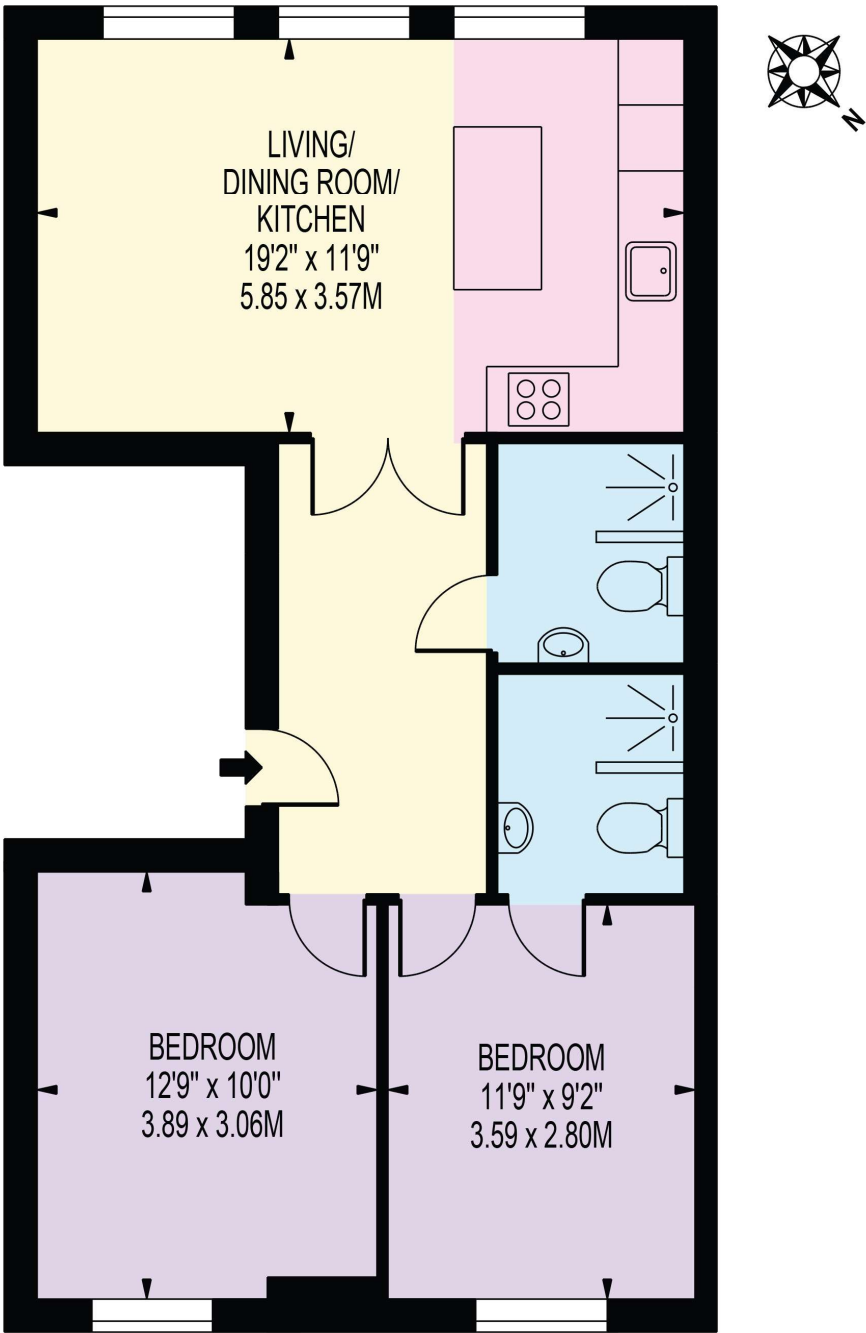

THIRD FLOOR

FOR ILLUSTRATION PURPOSES ONLY

THIS FLOOR PLAN SHOULD BE USED AS A GENERAL OUTLINE FOR GUIDANCE ONLY AND DOES NOT CONSTITUTE IN WHOLE OR IN PART AN OFFER OR CONTRACT. ANY INTENDING PURCHASER OR LESSEE SHOULD SATISFY THEMSELVES BY INSPECTION, SEARCHES, ENQUIRIES AND FULL SURVEY AS TO THE CORRECTNESS OF EACH STATEMENT. ANY AREAS, MEASUREMENTS OR DISTANCES QUOTED ARE APPROXIMATE AND SHOULD NOT BE USED TO VALUE A PROPERTY OR BE THE BASIS OF ANY SALE OR LET.