



Stylish One-Bedroom Apartment – River Park Tower

# NINE ELMS LANE

NINE ELMS, SW8

£1,065 per week

**BERKSHIRE  
HATHAWAY**  
HOMESERVICES

LONDON

# PROPERTY DETAILS

<b>Guide Price</b> £1,065 per week	<b>Square Footage</b> 664
<b>Council Tax Band</b> E	<b>EPC Rating</b> B

Located on the 7th floor of the sought-after River Park Tower at 1 Nine Elms Lane, this beautifully finished one-bedroom apartment offers modern living in one of London's most exciting riverside developments

Residents benefit from an excellent range of on-site amenities, including a 24-hour concierge, gym, pool, spa, private cinema, and a large indoor playroom that's child-friendly and perfect for babies and young children , a rare addition for families.

Ideally located just moments from Battersea Power Station, the U.S. Embassy, and within easy reach of Vauxhall and Nine Elms stations, this is a fantastic opportunity to live in a high-quality home in a thriving neighbourhood.

## FEATURES

- One Bedroom
- One Reception Room
- One Bathroom
- Concierge/Porter
- Lift
- Furnished
- New Development

## LOCATION



### KNIGHTSBRIDGE LETTINGS

55-57 SLOANE AVENUE, SW3 3DH

020 7235 9641

lettings.knightsbridge@bhhs-london.com





# FLOORPLAN

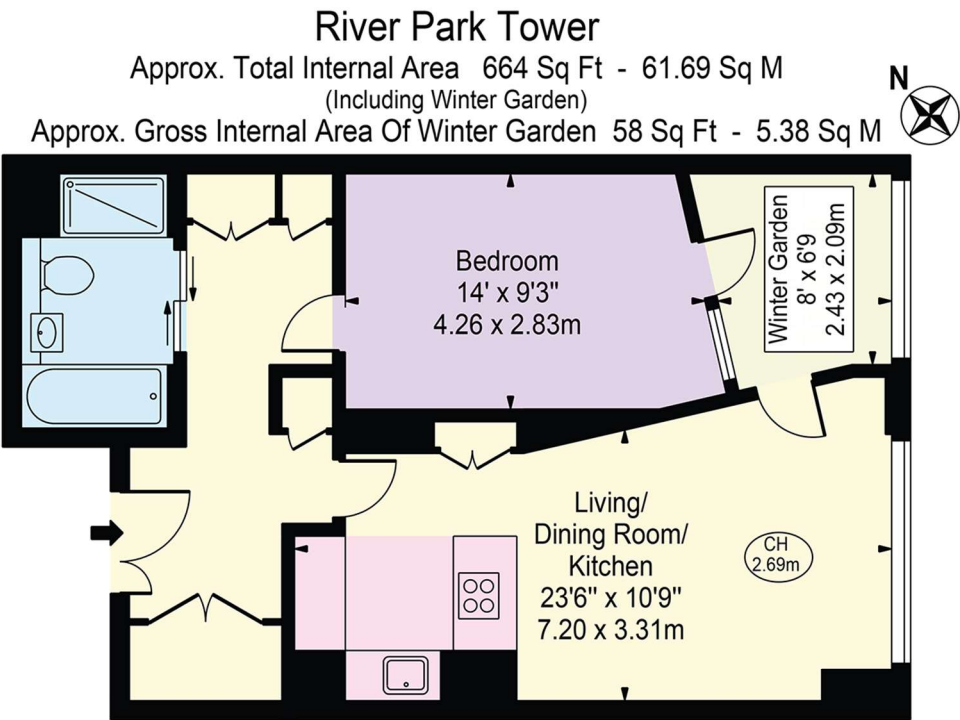

**Seventh Floor**  
For Illustration Purposes Only - Not To Scale

This floor plan should be used as a general outline for guidance only and does not constitute in whole or in part an offer or contract.  
Any intending purchaser or lessee should satisfy themselves by inspection, searches, enquiries and full survey as to the correctness of each statement.  
Any areas, measurements or distances quoted are approximate and should not be used to value a property or be the basis of any sale or let.  
Copyright Morriarti Photography & Design LTD