



A Split Level Three-Bedroom Duplex Located in the Heart of Paddington.

BISHOPS BRIDGE ROAD

HYDE PARK, W2

£825 per week

**BERKSHIRE
HATHAWAY**
HOMESERVICES

LONDON

PROPERTY DETAILS

Guide Price £825 per week	Square Footage 939
Council Tax Band D	EPC Rating C

HMO friendly! A split level three-bedroom duplex located in the heart of Paddington.

Across two levels, this bright spacious home splits its living space across two practical areas.

The entrance level boasts a separate kitchen with modern appliances, a reception room/ living area which perfect for dining and entertaining and flows onto a private balcony.

There is also a storage cupboard and finally a practical WC which completes the floor.

Going upstairs you find three double bedrooms, all of which enjoy private access to their own balconies, along with a contemporary family bathroom.

Located moments away from both Westbourne Grove and Paddington basin, this fantastic apartment benefits from an abundance of local shops, coffee houses and restaurants. The open spaces of Hyde Park are also within walking distance.

Transport access can be found at Paddington Station which provides access onto Elizabeth Line, District, Circle, Bakerloo, Hammersmith and City lines along with National Rail and central line access within walking distance at Lancaster Gate

FEATURES

- Three Bedrooms
- One Reception Room
- One Bathrooms
- Balcony
- Upper Floor
- Lift

LOCATION

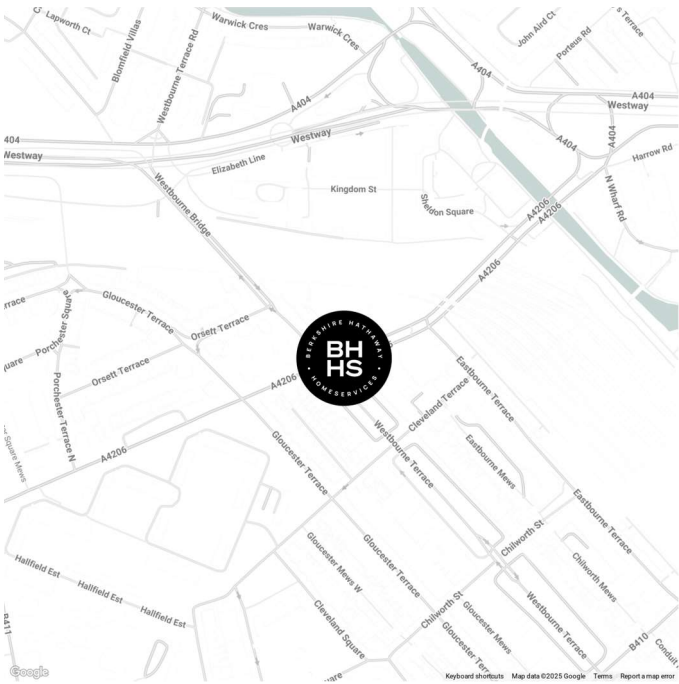

HYDE PARK LETTINGS
24-25 Albion Street, W2 2AX

020 7262 2030
lettings.hydepark@bhhs-london.com



FLOORPLAN

Brewers Court

Approx. Gross Internal Area 915 Sq Ft - 85.01 Sq M
Approx. External Area Of Balconies 120 Sq Ft - 11.15 Sq M

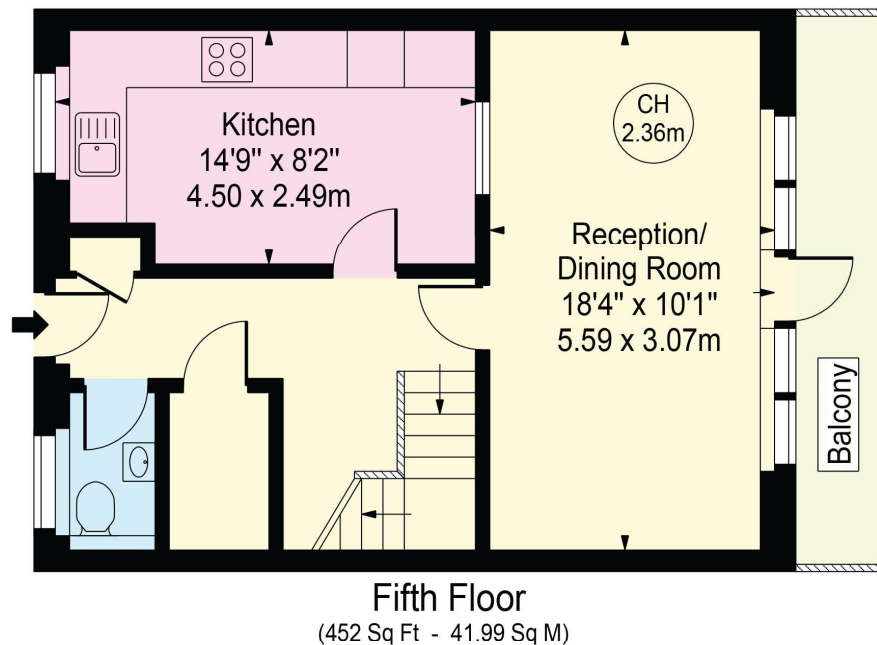
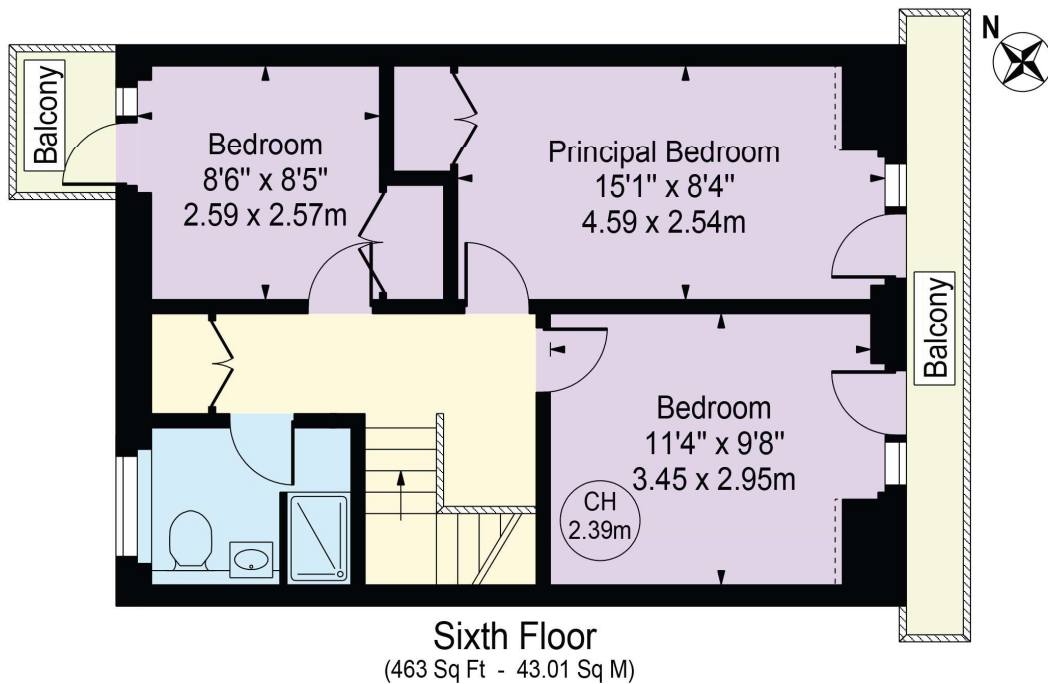

For Illustration Purposes Only - Not To Scale

This floor plan should be used as a general outline for guidance only and does not constitute in whole or in part an offer or contract.
Any intending purchaser or lessee should satisfy themselves by inspection, searches, enquiries and full survey as to the correctness of each statement.
Any areas, measurements or distances quoted are approximate and should not be used to value a property or be the basis of any sale or let.

Copyright Morriarti Photography & Design LTD