



A NEWLY REFURBISHED TWO BEDROOM APARTMENT
LOCATED ON SLOANE STREET

SLOANE STREET

BELGRAVIA, SW1X

£925 per week

**BERKSHIRE
HATHAWAY**
HOMESERVICES

LONDON

PROPERTY DETAILS

Guide Price £925 per week	Square Footage 671
Council Tax Band G	EPC Rating C

A bright and spacious fourth-floor apartment, recently refurbished to a high standard, offering lift access and a porter, located in the heart of Knightsbridge on the prestigious Sloane Street.

Overlooking the beautiful Cadogan Place Gardens, this charming property boasts a spacious, bright reception room, a modern kitchen, a stylish bathroom, and two well-sized double bedrooms.

This elegant apartment is situated on the ever-popular Sloane Street, equidistant to Sloane Square to the south and Knightsbridge to the north—a location that is unparalleled in its access to shopping boutiques, coffee houses, bars, and top-tier restaurants.

Situated just a 5-minute walk from Sloane Square station (Circle & District Lines) and within easy reach of Victoria station (1 mile away), with Knightsbridge also within walking distance, the property offers excellent transport links.

FEATURES

- Two Bedrooms
- One Bathroom
- Lift
- Residents Parking
- Communal Gardens

LOCATION

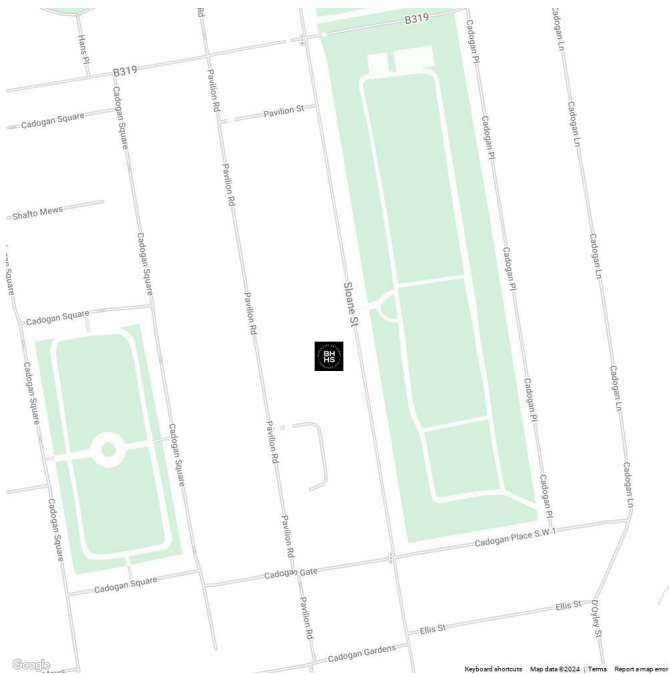

KNIGHTSBRIDGE LETTINGS

55-57 SLOANE AVENUE, SW3 3DH

020 7235 9641

lettings.knightsbridge@bhhs-london.com



FLOORPLAN

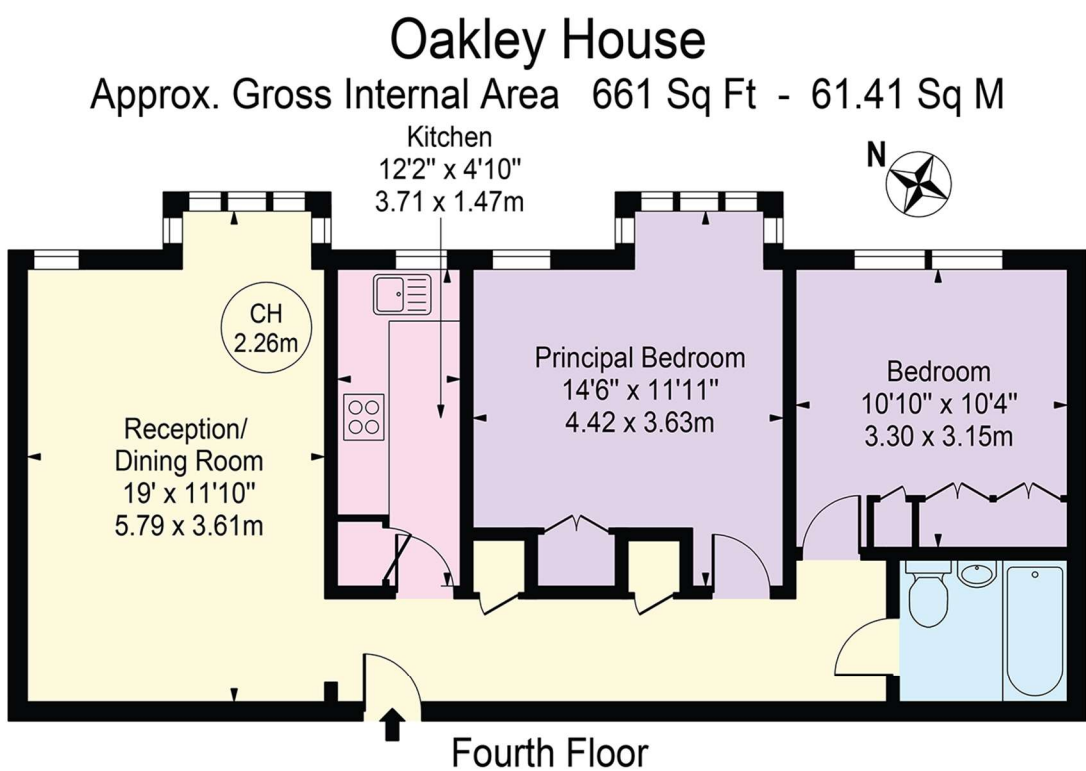

For Illustration Purposes Only - Not To Scale

This floor plan should be used as a general outline for guidance only and does not constitute in whole or in part an offer or contract.
Any intending purchaser or lessee should satisfy themselves by inspection, searches, enquiries and full survey as to the correctness of each statement.
Any areas, measurements or distances quoted are approximate and should not be used to value a property or be the basis of any sale or let.
Copyright Morriarti Photography & Design LTD