



Delightful Two Bedroom Apartment Adjacent to
Hyde Park

ALBION GATE

HYDE PARK ESTATE, W2

£923 per week

**BERKSHIRE
HATHAWAY**
HOMESERVICES

LONDON

PROPERTY DETAILS

Guide Price £923 per week	Square Footage 936
Council Tax Band G	EPC Rating C

This charming two-bedroom apartment in Albion Gate, W2, offers over 900 sq ft of well-appointed living space in one of London's most desirable central locations. Albion Gate enjoys an exceptional position with outstanding transport connections. Marble Arch Underground Station (Central Line) is just a short walk away, while nearby Paddington Station offers access to the Bakerloo, District, Circle, and Hammersmith & City Lines, as well as National Rail services, the Heathrow Express, and the high-speed Elizabeth Line.

Set between Marylebone and Mayfair, Connaught Village is known for its boutique shops, artisanal cafés, and relaxed community feel. The world-class shopping and dining of Oxford Street, Selfridges, and Bond Street are within walking distance, while the green open spaces of Hyde Park are just across the road, offering the perfect urban escape. Combining elegant living with exceptional transport and access to London's top universities and business hubs, this property is a superb choice for anyone seeking quality and convenience in the heart of the capital.

FEATURES

- Two Bedrooms
- One Reception Room
- One Bathroom
- Concierge/Porter
- Upper Floor
- Lift

LOCATION



HYDE PARK LETTINGS
24-25 Albion Street, W2 2AX

020 7262 2030
lettings.hydepark@bhhs-london.com



FLOORPLAN

Albion Gate

Approx. Gross Internal Area 919 Sq Ft - 85.38 Sq M

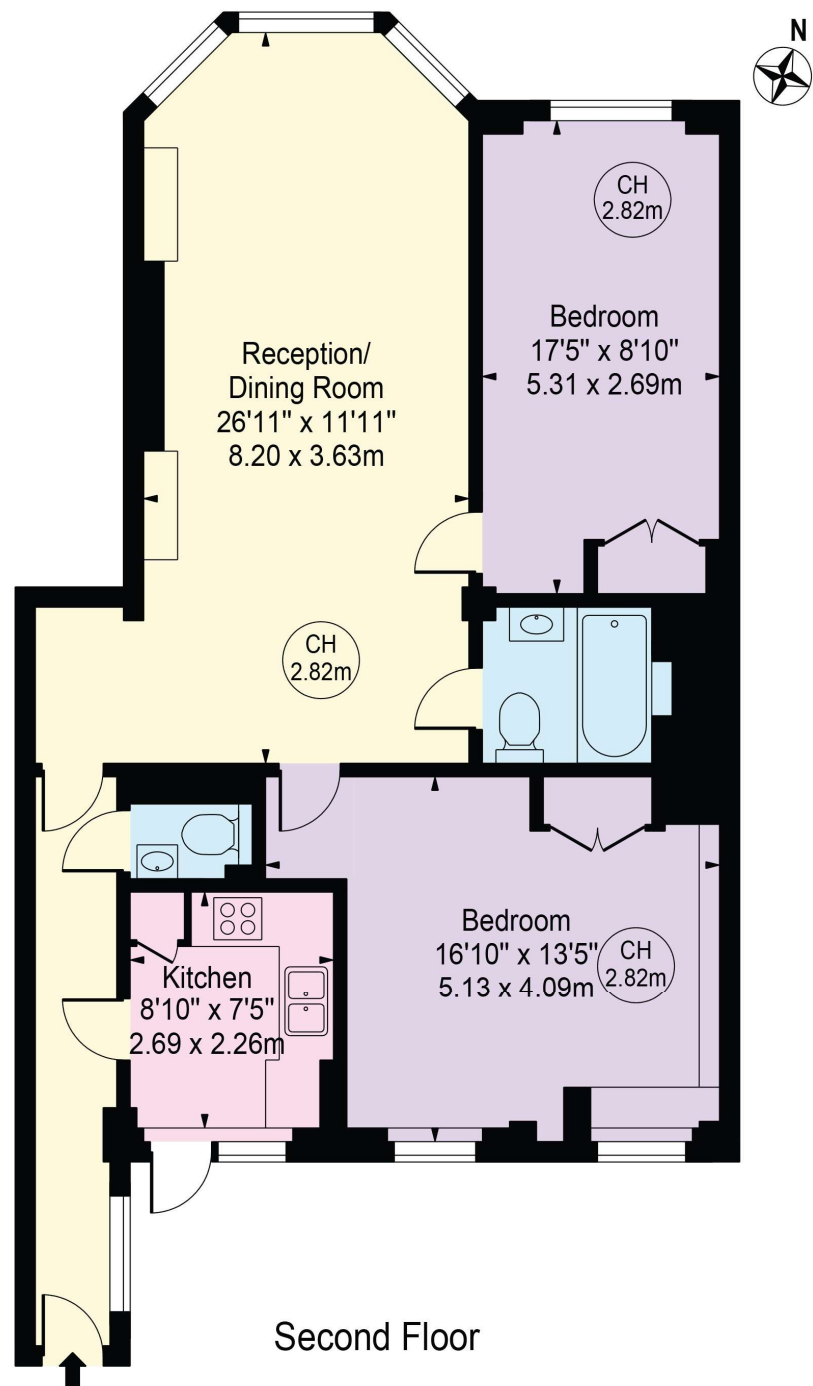

For Illustration Purposes Only - Not To Scale

This floor plan should be used as a general outline for guidance only and does not constitute in whole or in part an offer or contract. Any intending purchaser or lessee should satisfy themselves by inspection, searches, enquiries and full survey as to the correctness of each statement. Any areas, measurements or distances quoted are approximate and should not be used to value a property or be the basis of any sale or let.