



STUNNING STUDIO IN PRIME PLIMSOLL BUILDING

PLIMSOLL BUILDING

HANDYSIDE STREET, N1C

Asking Price
£575,000

**BERKSHIRE
HATHAWAY**
HOMESERVICES

LONDON

PROPERTY DETAILS

Guide Price £575,000	Square Footage 351
Council Tax Band E	EPC B
Ground Rent £350 pa	Service Charge £3600 pa
Tenure Leasehold	

A spacious studio apartment in one of King's Cross' most popular developments, the Plimsoll Building.

Residents benefit from a 24-hour concierge service, private dining space and lounge, a well-equipped fitness suite, beautiful courtyard garden and roof terrace.

Nearby transport links include St. Pancras International and King's Cross Station (Northern, Victoria, Hammersmith & City, Metropolitan, Circle and Piccadilly lines, National Rail) providing frequent services into the City and the West End.

Vibrant Coal Drops Yard and Granary Square are also moments away with their array of boutiques, bars, restaurants, and cultural offers.

FEATURES

Studio
One Reception Room
One Bathroom
Concierge/ Porter
24 Hour Security
Lift
Roof Terrace
Communal Gardens

LOCATION



KINGS CROSS SALES

Unit 4,6 Pancras Square, N1C 4AG

020 7467 2020

sales.kingscross@bhhs-london.com



FLOORPLAN

PLIMSOLL BUILDING

APPROXIMATE GROSS INTERNAL FLOOR AREA: 351 SQ FT - 32.61 SQ M

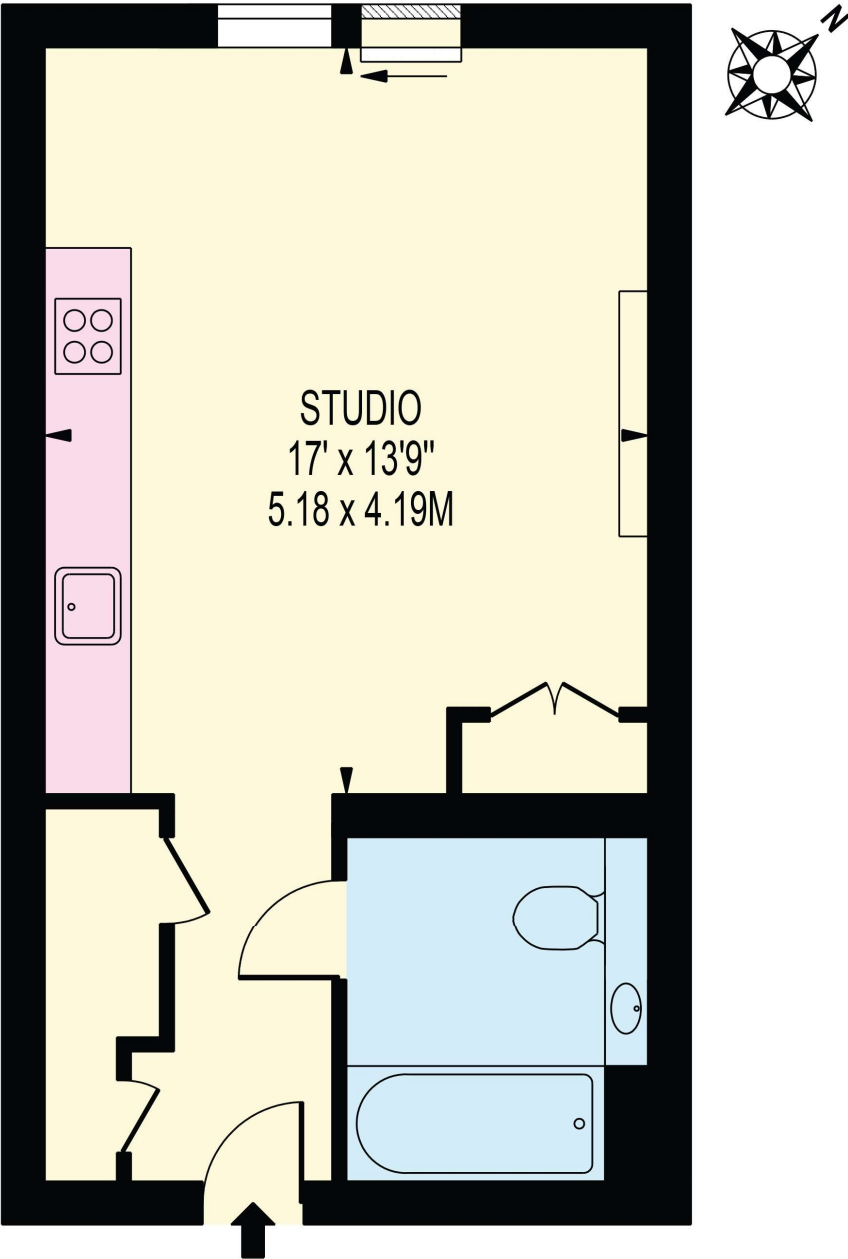

THIRD FLOOR

FOR ILLUSTRATION PURPOSES ONLY

THIS FLOOR PLAN SHOULD BE USED AS A GENERAL OUTLINE FOR GUIDANCE ONLY AND DOES NOT CONSTITUTE IN WHOLE OR IN PART AN OFFER OR CONTRACT. ANY INTENDING PURCHASER OR LESSEE SHOULD SATISFY THEMSELVES BY INSPECTION, SEARCHES, ENQUIRIES AND FULL SURVEY AS TO THE CORRECTNESS OF EACH STATEMENT. ANY AREAS, MEASUREMENTS OR DISTANCES QUOTED ARE APPROXIMATE AND SHOULD NOT BE USED TO VALUE A PROPERTY OR BE THE BASIS OF ANY SALE OR LET.