



Modern Complex in the Heart of Paddington

MERCHANT SQUARE EAST

—PADDINGTON, W2

- Three Bedrooms
- Two Bathrooms
- Kitchen
- Reception
- Lift Access
- Concierge/Porter,
- 944 Sq Ft Approximately
- Energy Rating: B

HYDE PARK & BAYSWATER LETTINGS

24-25 Albion Street, London, W2 2AX

020 7262 2030

lettings.hydepark@kayandco.com

kayandco.com

£1,350 p/w (£5,850 pcm) LONG LET

MERCHANT SQUARE EAST

—PADDINGTON, W2

We are pleased to offer this stunning interior designed apartment, set within the heart of Paddington Basin and close to the popular West End Quay. The apartment is situated on the third floor of this prestigious building which features 24 hour concierge, lift service, and secure underground parking. This apartment comprises spacious living and entertaining space with a beautiful reception room with superb views over the Grand Union

Canal, a modern open plan kitchen, three bedrooms, two bathrooms, guest WC, and ample storage space. The apartment offers excellent access to transport links such as Paddington Train Station (Bakerloo, Hammersmith & City, Circle, District lines and Heathrow) and Edgware Road (Circle, District and Bakerloo lines) both within a short walk. (NB: Photos represent typical three bedroom apartment within the complex).

£1,350 p/w (£5,850 pcm) LONG LET

EPC RATING - B





Consumer Protection from Unfair Trading Regulations 2008. These details are for guidance only and complete accuracy cannot be guaranteed. If there is any point, which is of particular importance, verification should be obtained. They do not constitute a contract or part of a contract. All measurements are approximate. No guarantee can be given with regard to planning permissions or fitness for purpose. No apparatus, equipment, fixture or fitting has been tested. Items shown in photographs are NOT necessarily included. Interested Parties are advised to check availability and make an appointment to view before travelling to see a property.

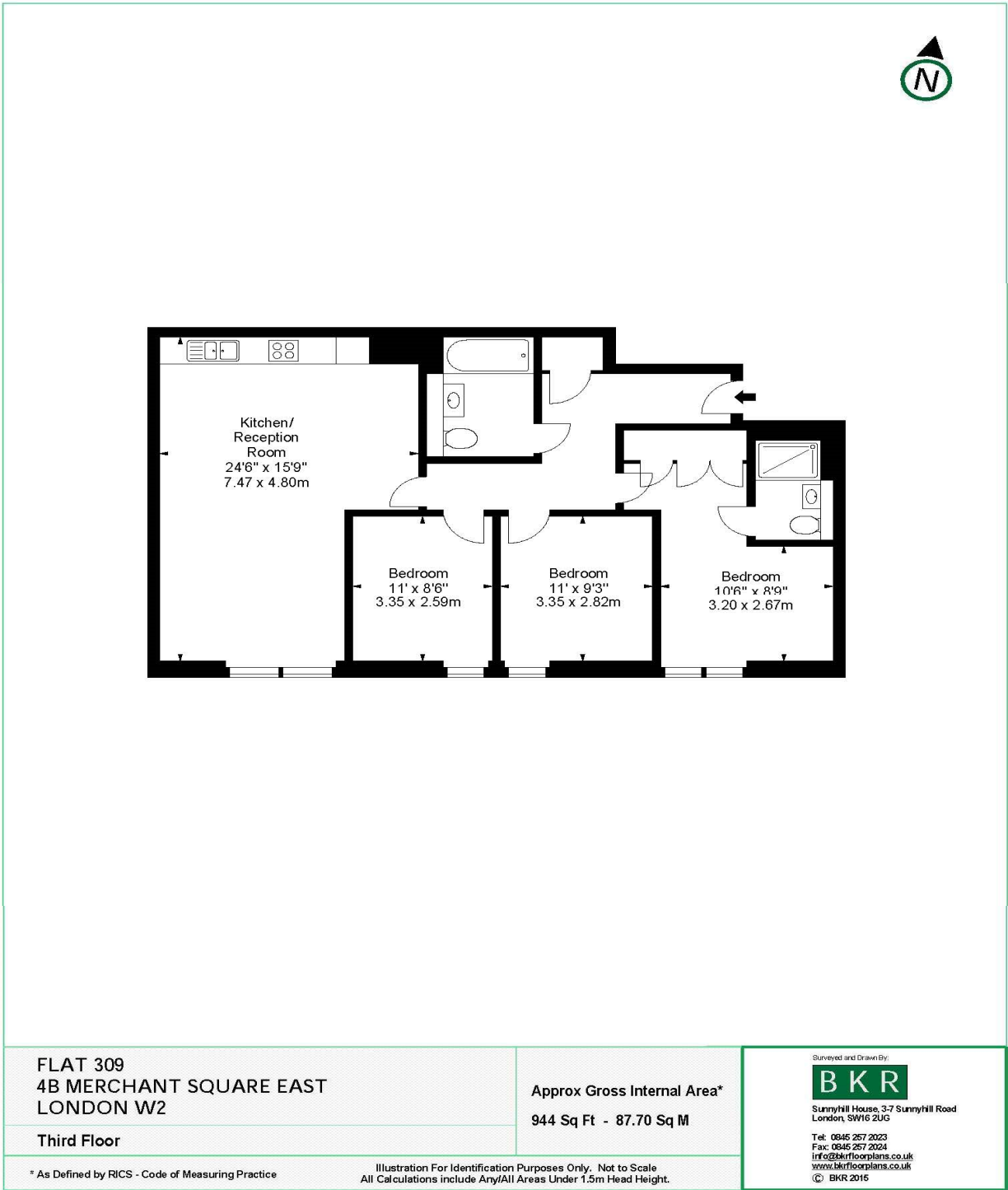

**BERKSHIRE
HATHAWAY**
HomeServices

Kay & Co